

1

Remove existing control box – leave legs attached to feeder. Plug funnel if needed.

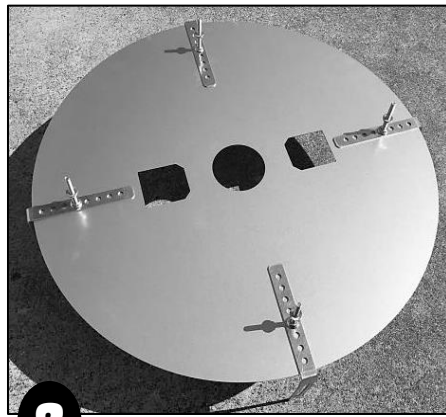

2

Attach (4) L-Brackets to top plate. Position bolt in 4<sup>th</sup> hole from bend for 55 gal barrel feeder.

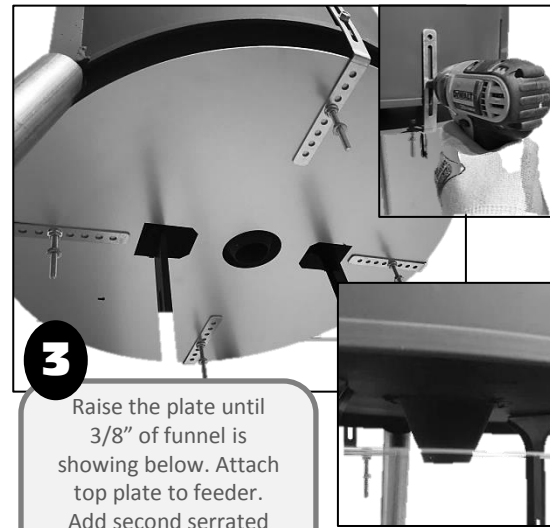

3

Raise the plate until 3/8" of funnel is showing below. Attach top plate to feeder. Add second serrated nut to bolt.

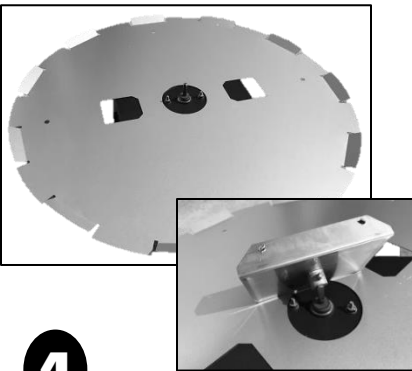

4

Place bottom plate on control box and attach spinner plate.

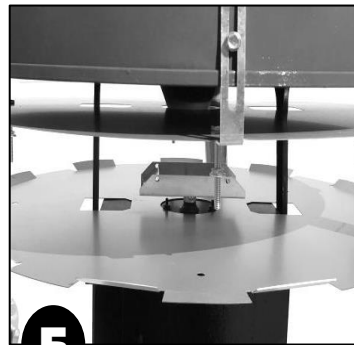

5

Re-attach control box to legs and hand tighten box nuts.

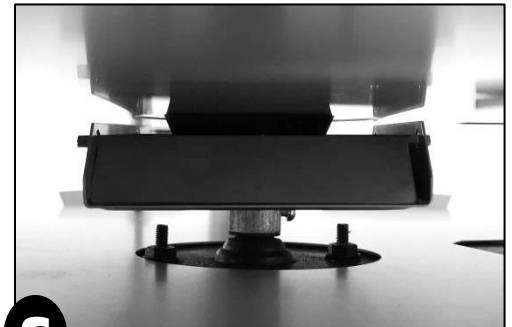

6

Raise control box to bottom of funnel... top of spinner plate should be 1/4" - 3/8" below top plate. Tighten control box nuts.



7

Align bottom plate holes to bolts. Add nut to move bottom plate up.

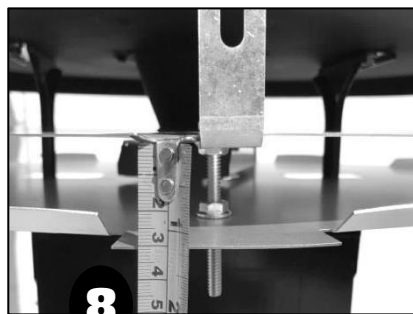

8

Raise bottom plate to 3/8" below spinner plate.

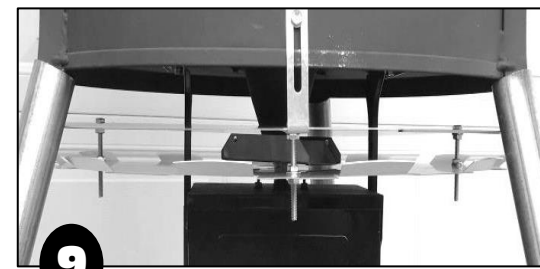

9

Make final adjustments to spinner & plate position. Spinner must be free of interference.

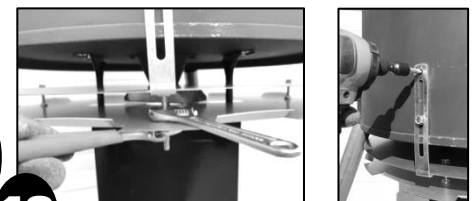

10

When adjustments are complete tighten all hardware. Attach second screw in L-Bracket.



**Warning!**

This product may have sharp edges. Please handle with care and wear gloves.

*Always read and follow safety and installation instructions.*

# ProThro QUICK 10

## Installation Instructions

**1. WARNING:** Use this product only in the manner intended. **2. WARNING:** During handling and installation, always wear appropriate thick leather gloves, safety glasses, hard hat, and any other safety equipment deemed necessary to avoid injury. **3. WARNING:** Wear durable work gloves at all times when handling this unit!