

# ProThrow 360 INSTALLATION INSTRUCTIONS

- Coon Proof • Broadcasts Feed Farther • Distributes Feed Away From The Feeder • Less Competition Under The Feeder • Easy Installation • Saves Money

SAFETY & TOOLS



## Warning!

This product may have sharp edges. Please handle with care and wear gloves.

*Always read and follow safety and installation instructions.*



### TOOLS NEEDED

- Cordless Drill
- 7/16" Driver for Cordless Drill
- Tape Measure
- Phillips & Flat Screw Driver
- (2) 7/16" Box End Wrenches or Crescent Wrenches
- Cloth To Plug Funnel

### SAFETY EQUIPMENT NEEDED

- Safety Glasses
- Thick/Durable Work Gloves
- Hard Hat

### PARTS DESCRIPTION:

- A. Top Plate - 1
- B. Bottom Plate - 1
- C. L-Bracket - 4
- D. Bolts - 4
- E. Serrated Nuts - 12
- F. Self Tapping Screws - 8

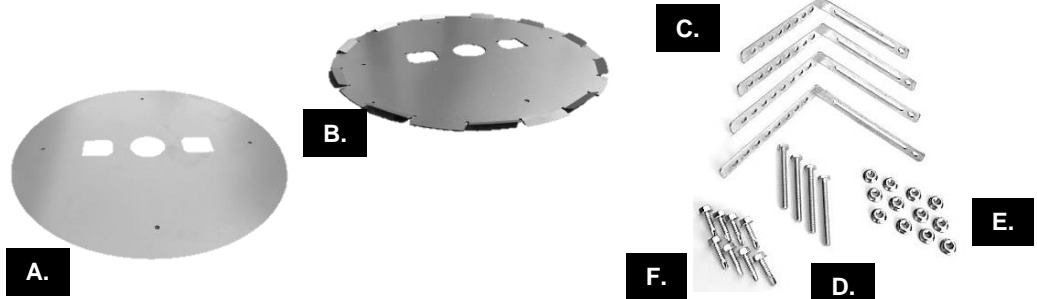

PARTS

### Attach L-Brackets

1. Attach (4) L-Brackets to the Top Plate as shown and tighten serrated nuts.
2. L-Bracket should be below the Top Plate for support.
3. Slotted side of the L-Bracket should be facing upward and will attach to the feeder.
4. Start serrated nuts for bottom plate. Spin to approximately 1 1/2" of top plate nut. Be sure the flat serrated surface is to the plate.

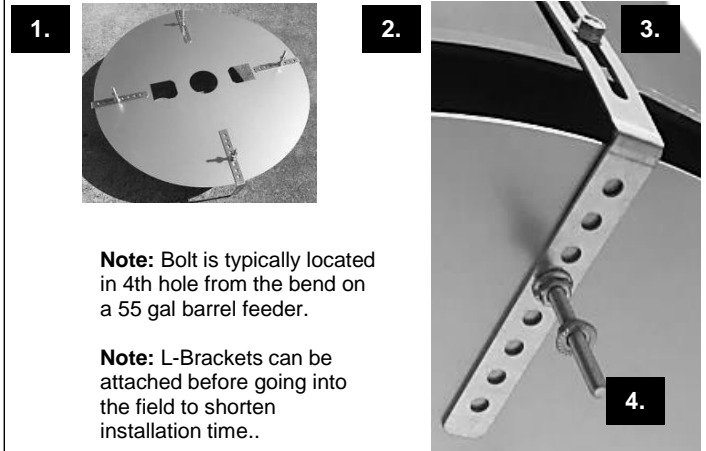

L - BRACKETS

### Remove Existing Control Box If Present

1. Remove existing control box from box legs.  
**IMPORTANT:** Leave the two legs attached to the feeder.
2. If feed is in the feeder plug the funnel to prevent loss of feed. The plug will be removed later.
3. Remove spinner plate from control box and set aside.

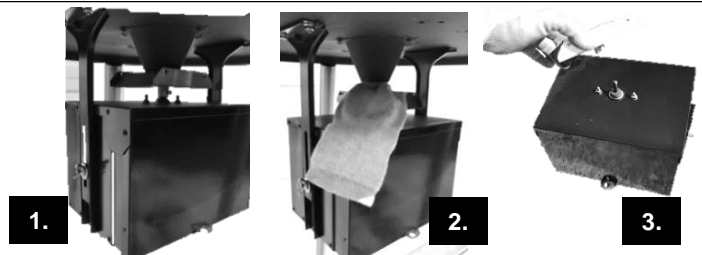

CONTROL BOX

### Attaching The Top Plate To The Feeder

1. Center the Top Plate over the funnel approximately 3/8" above the end of the funnel.
2. Position self tapping screws in the slotted portion of the L-Bracket and secure all (4) to the feeder.
3. **IMPORTANT:** do not overtighten self tapping screws to avoid stripping.

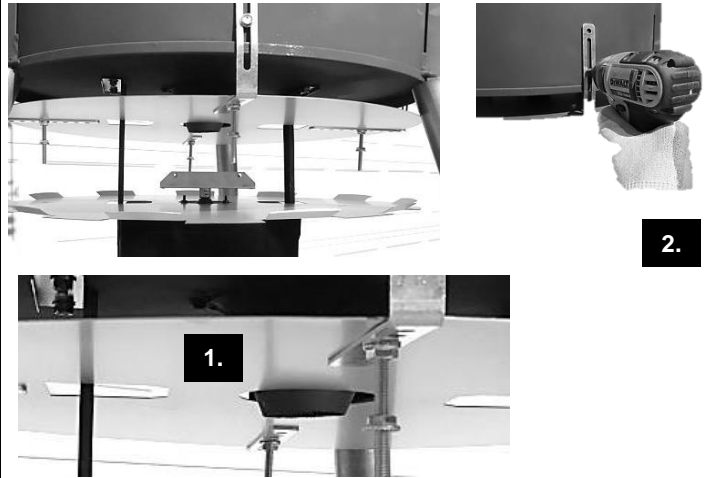

### Attach Bottom Plate and Spinner Plate

1. Rest Bottom Plate on top of the control box as shown. **IMPORTANT:** The fins should be directed upward.
2. Re-attach the Spinner Plate to the motor shaft.
3. **IMPORTANT:** Spinner Plate set screw should set into the flat portion of the shaft.

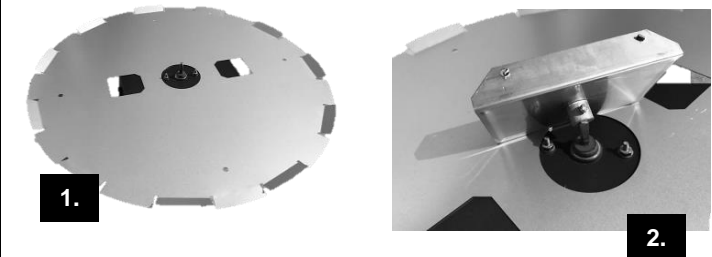

### Attach Control Box And Bottom Plate To The Feeder

1. Re-attach the control box to the box legs on the feeder and hand tighten control box nuts.
2. Align the bolt holes on the Bottom Plate with the bolts from the Top Plate and install serrated nuts below the Bottom Plate.
3. Raise control box until the funnel tip is level with, or just below, the top of the Spinner Plate and tighten control box nuts.

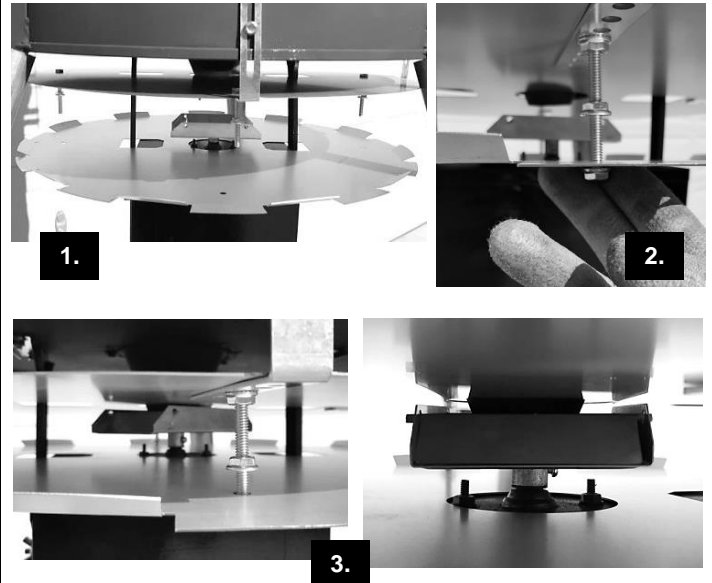

### Fine Tune Distance Between Plates

1. Use wrenches to adjust the nuts on the Bottom Plate and position the Bottom Plate just below the funnel tip.
2. Raise the Bottom Plate by tightening the bottom serrated nuts. Move the Bottom Plate to 1/4" - 3/8" below the bottom of the spinner plate.
3. Measure the gap spacing between the Top and Bottom plates after the plates are positioned correctly.
4. Adjust the other (3) bolt gaps so the spacing is the same on all.

**Note:** The varmint's ability to reach the spinner plate is limited by the gap distance between plates. However, it is critical for the Spinner Plate to have clearance and spin freely.

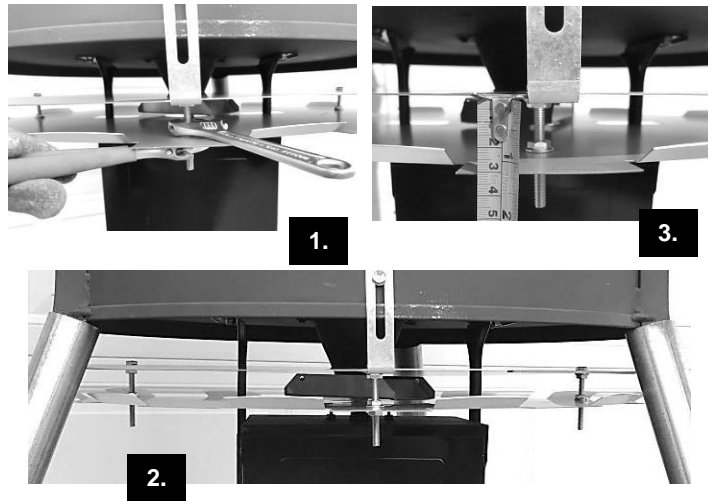

### Final Adjustments And Tightening

1. When all plates are positioned correctly, hand spin the Spinner Plate to be sure there is no interference. If there is interference, immediately adjust the Spinner and Plate positions for clearance.
2. When all final positioning is complete and Spinner Plate tested for obstruction, firmly tighten all Serrated and Control Box nuts.
3. Place a second self tapping screw into the top hole of the L-Bracket as shown. This second screw helps to assure that the plates don't shift from vibration and use.

